

OUTPUT SHAFT COUPLING & PROPELLER COUPLING DIMENSION

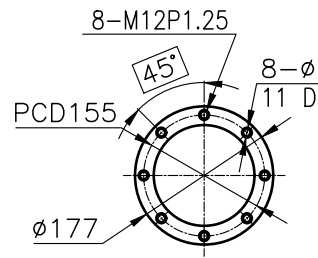

INPUT COUPLING DIMENSION

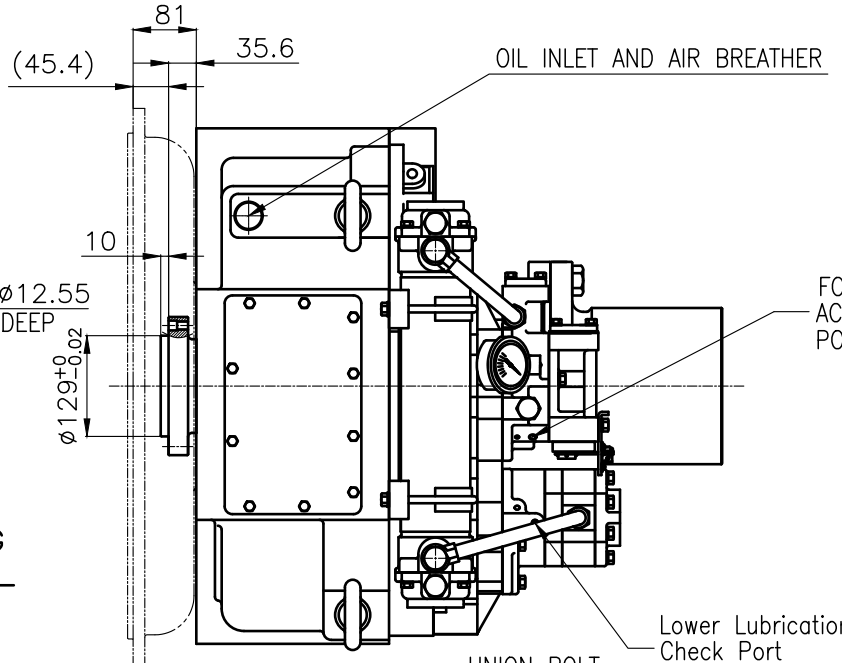

OIL INLET AND AIR BREATHER

FORWARD CLUTCH ACTUATING PRESSURE PORT (PT 1/8-28)

Lower Lubrication Pressure Check Port (PT 1/8-28)
UNION BOLT (M18P1.5)
PF2-11 BOTH SIDES (INLET OR OUTLET OF COOLING WATER)
ZINC ANODE

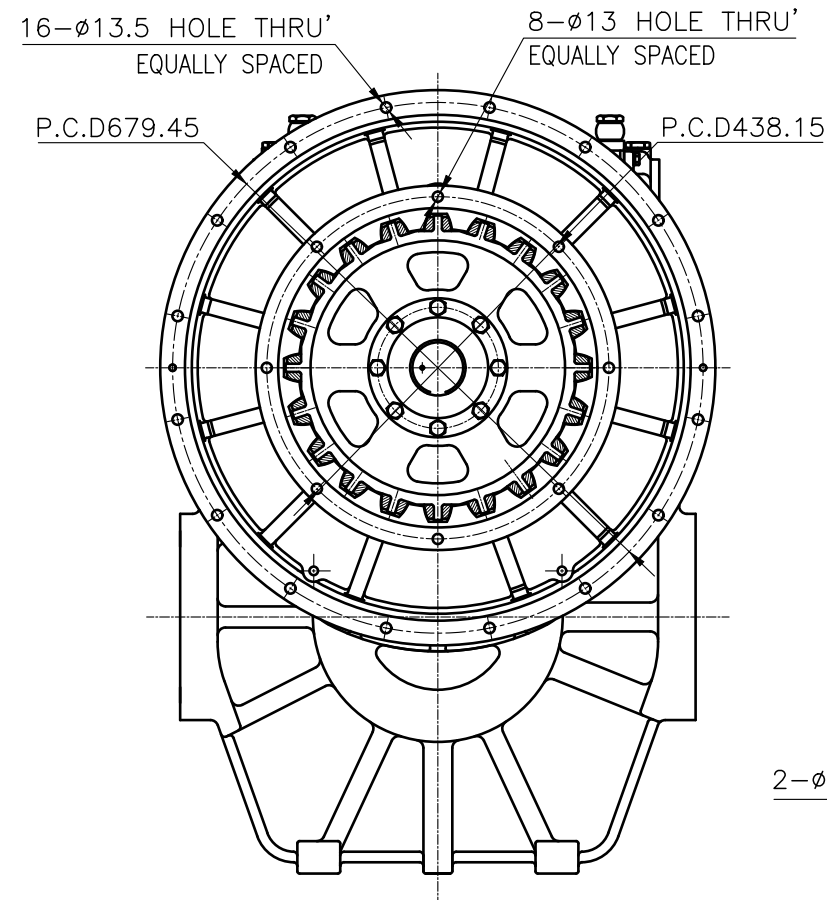

16-φ13.5 HOLE THRU' EQUALLY SPACED
8-φ13 HOLE THRU' EQUALLY SPACED
P.C.D.679.45
P.C.D.438.15

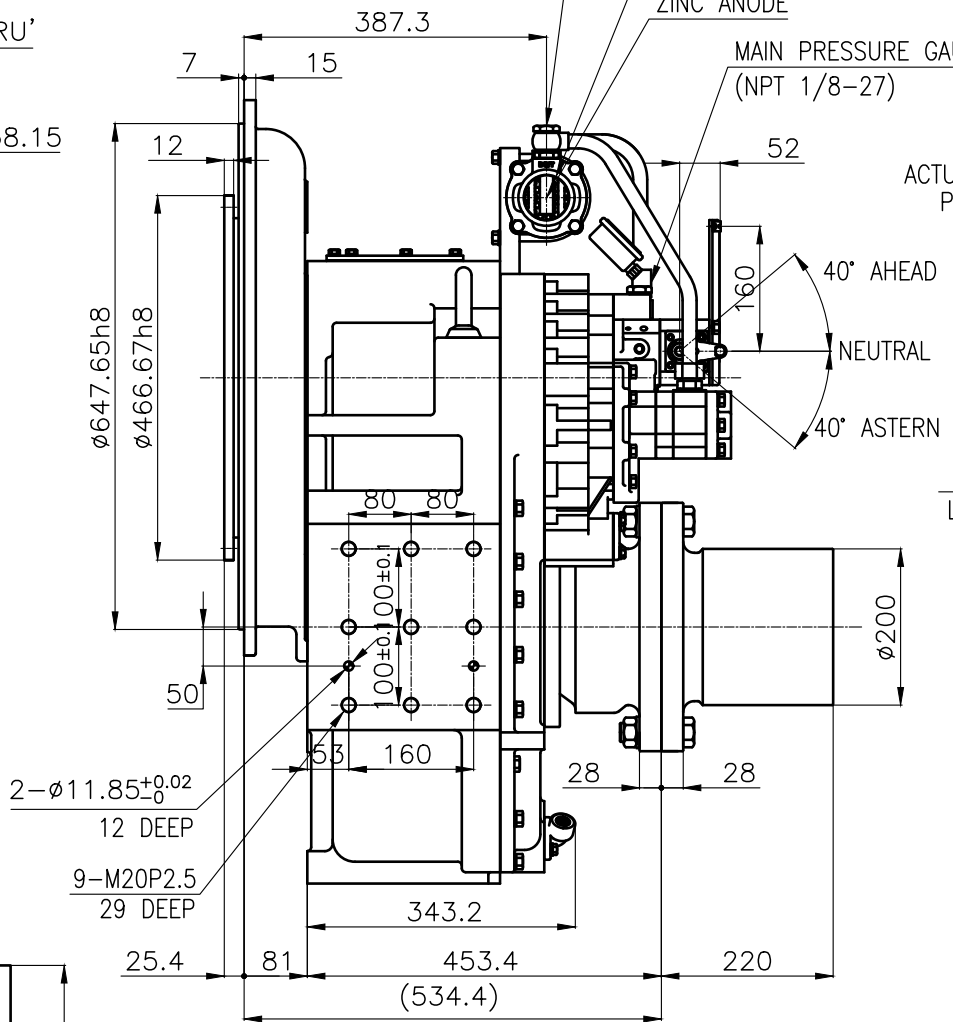

2-φ11.85±0.02 12 DEEP
9-M20P2.5 29 DEEP

REVERSE CLUTCH ACTUATING PRESSURE PORT (PT 1/8-28)

NIPPLE (M26P1.5, φ18)

EMERGENCY BOLT LOCATION (REVERSE)

REVERSE

DRAIN FLANGE PT 1/2-14

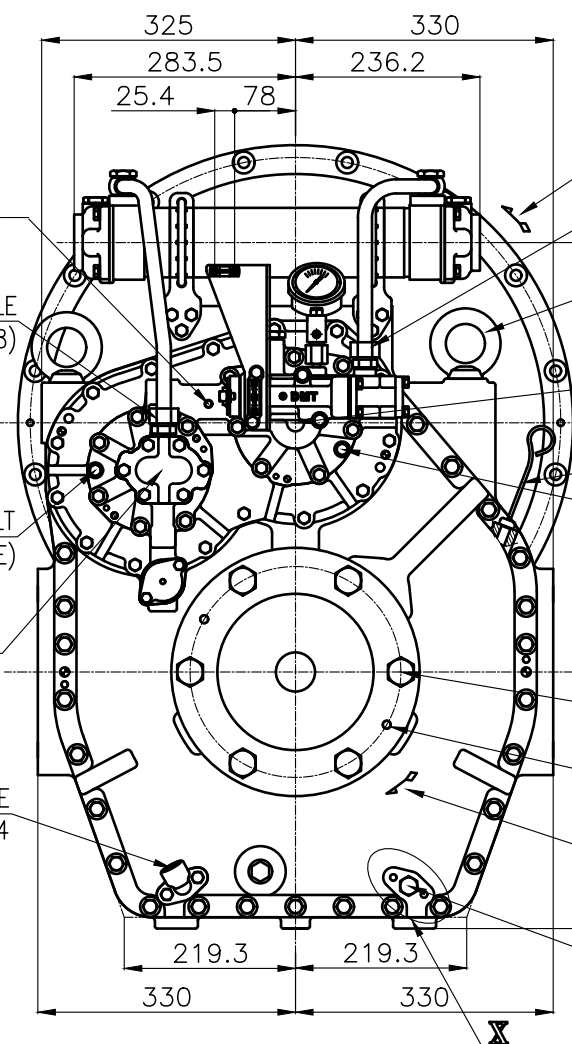

ENGINE DIRECTION OF ROTATION

NIPPLE (M26P1.5, φ18)

EYEBOLT FOR LIFTING MARINE TRANSMISSION (2-BOLTS ONE EACH SIDE)

FORWARD

OIL LEVEL GAUGE

EMERGENCY BOLT LOCATION (FORWARD)

6-φ25 REAMER BOLTS

2-M12P1.75 FOR JACK BOLTS

OUTPUT SHAFT DIRECTION OF ROTATION IN FORWARD

MAGNET PLUG M16P1.5

- REMARK
- 1.HOUSING: SAE#0
 - 2.DRIVING RING: SAE 14"
 - 3.COUPLING TYPE : RUBBER

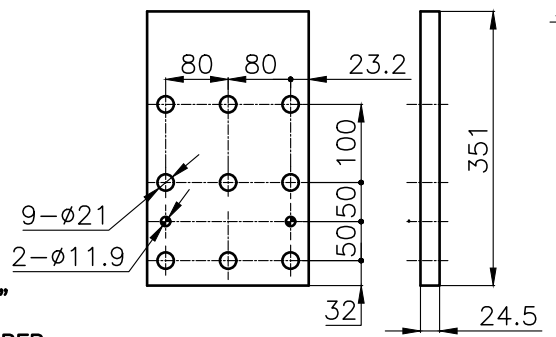

BRACKET DIMENSION

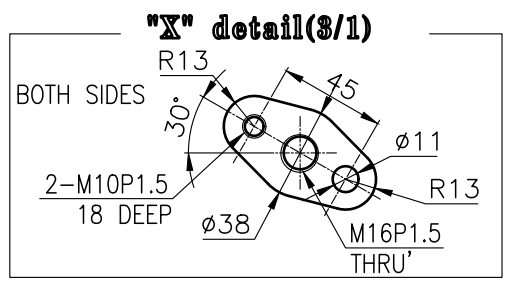

"X" detail(3/1)

公差 TOLERANCE ON				번호 NO.	부품 PART NO.	부품 PART NAME	개수 Q'TY	재질 MATERIAL	규격 SIZE	비고 REMARKS
분수 FRACTIONS	소수 DECIMALS	각도 ANGLES		재질 MATERIAL	작성 DATE	척도 SCALE	형식 TYPE	DMT300HL	원도 번호 ORIGINAL DWG. NO.	
±	±	±		인인 APPROVED BY	검도 CHECKED BY	제도 DRAWN	명명 NAME	MARINE TRANSMISSION	도 번호 DWG. NO.	개량 (REV.)
1 초과 4 이하	± 0.3	± 0.1	± 0.05	JK.Kim	TH.Cha	BJ.Moon	도 번호 DWG. NO.	30000GA~E-014RC	000	
4 16	± 0.5	± 0.2	± 0.07	D-I INDUSTRIAL		크기 SIZE	A 3	코드 번호 CODE ID. NO.		
16 63	± 0.7	± 0.3	± 0.1							
63 250	± 1.2	± 0.5	± 0.2							
250 1000	± 2.0	± 0.8	± 0.3							