

OUTPUT SHAFT COUPLING &  
PROPELLER COUPLING DIMENSION

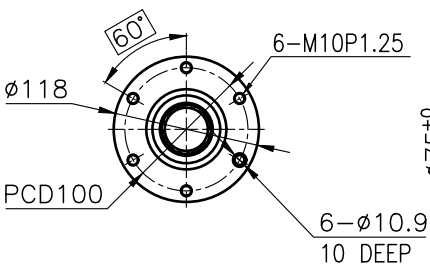

INPUT COUPLING  
DIMENSION

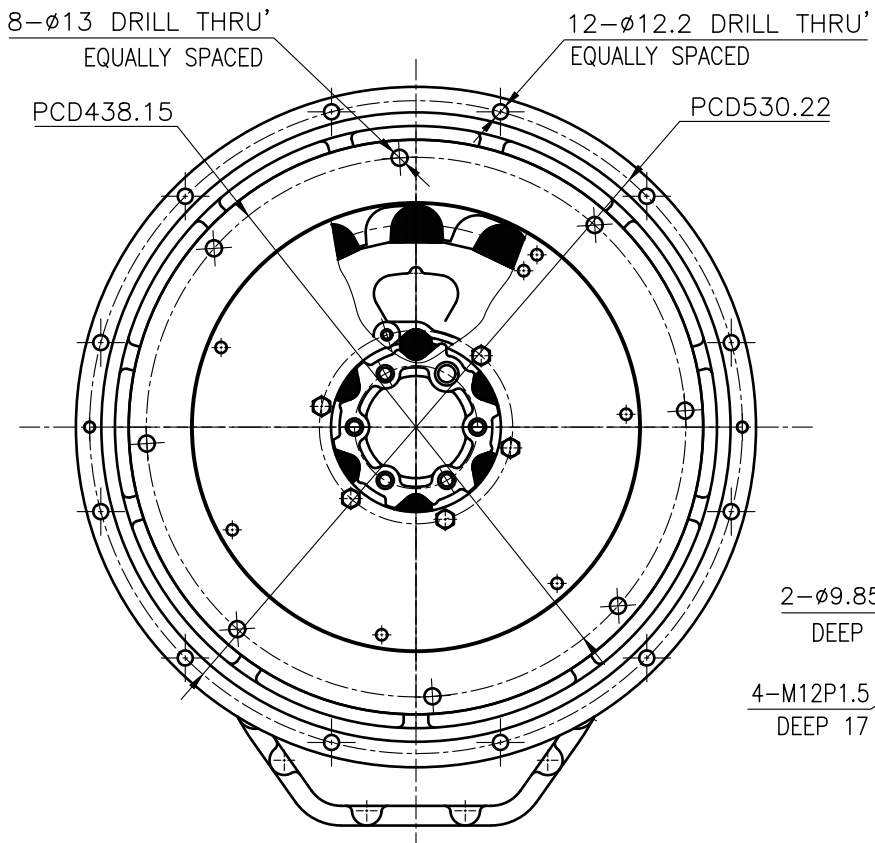
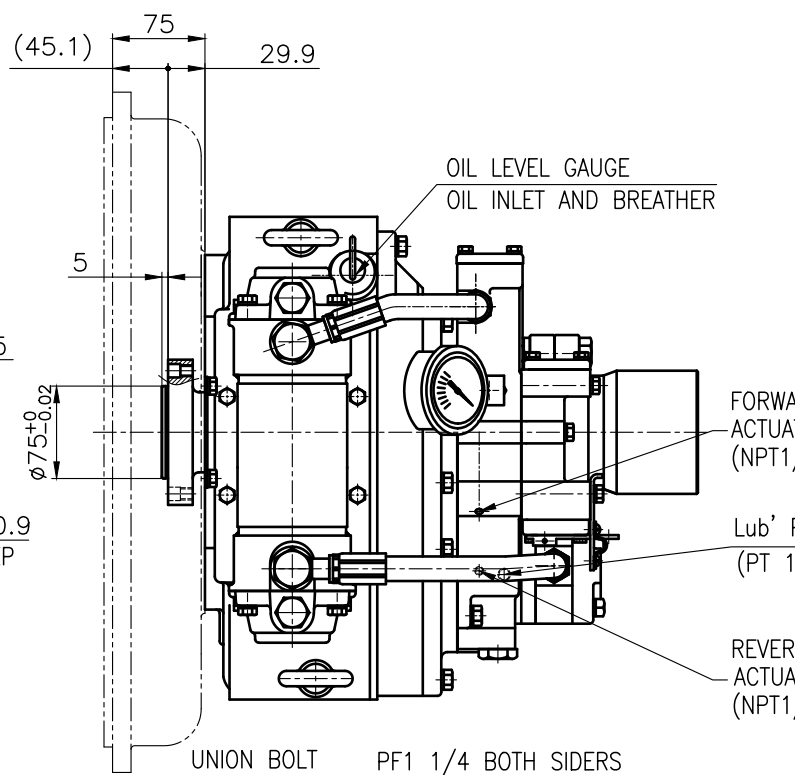

REMARK (HOT)  
1.HOUSING: SAE#1  
2.DRIVING RING: SAE 14"  
3.COUPLING TYPE : DUAL STAGE  
4.APPLICATION ENGINE : STANDARD

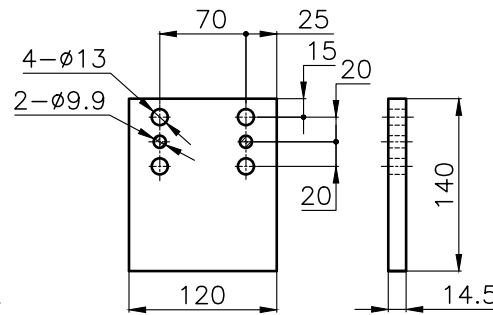

BRACKET DIMENSION

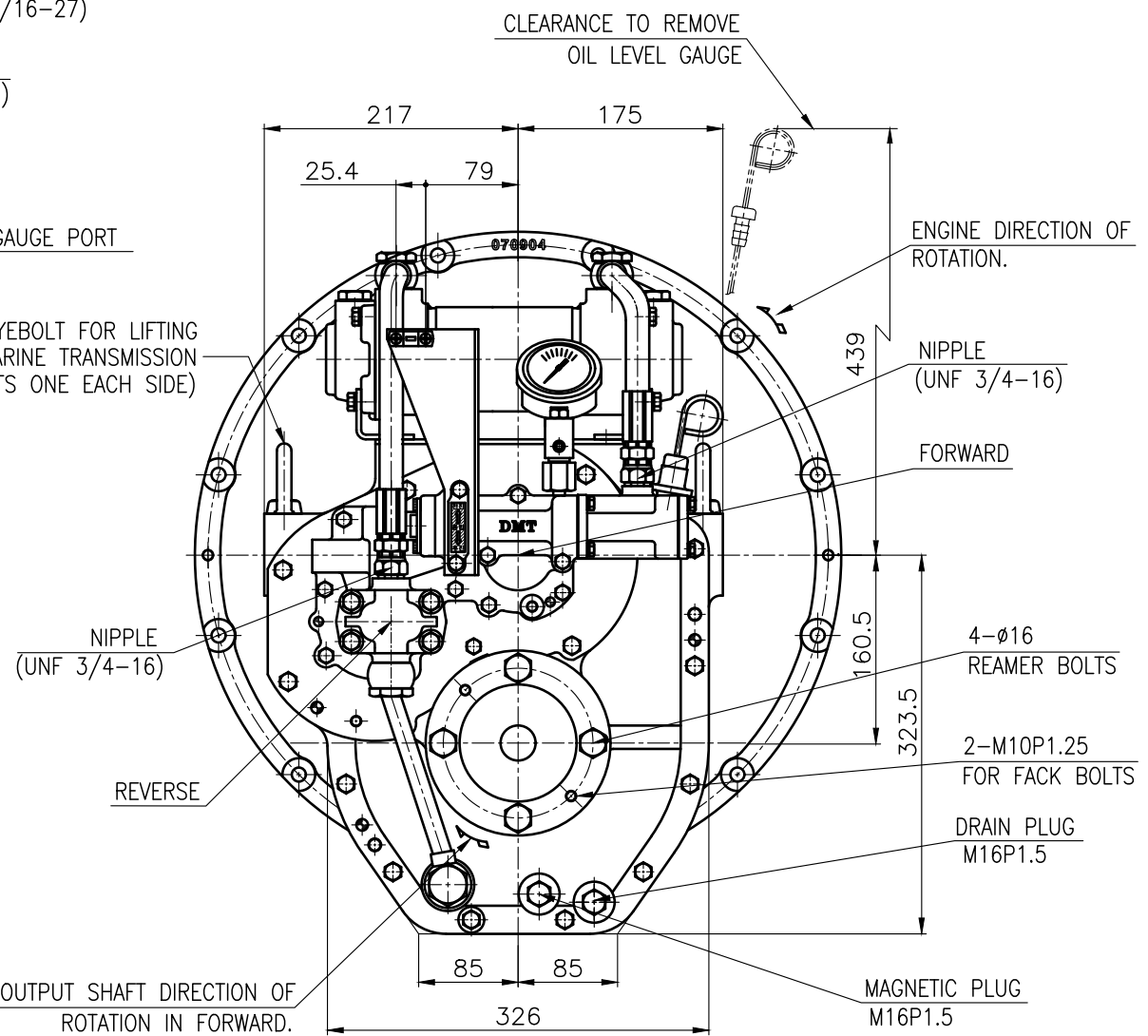

DMT 50A MARINE GEAR SPECIFICATION			
GEAR RATIO	1.61, 2.06, 2.45, 2.82, 3.12, 3.46		
TOTAL WEIGHT	APPROX. 143 kg(DRY)		
OIL CAPACITY	APPROX. 3L		
OIL VISCOSITY	SAE # 30		
OIL PRESSURE	1.96 ~ 2.54 MPa	CLUTCH OIL	
DIRECTION OF ROTATION IN FORWARD	INPUT	C.C.W VIEWED FROM THE STERN	
	OUTPUT	C.W VIEWED FROM THE STERN	
OIL CHANGE INTERVAL	THE FIRST 100HOURS OF INITIAL OPERATION		
	AND EVERY 1000HOURS THEREAFTER		
SHIFTING LIMIT	UNDER 50% OF THE RATED ENGINE SPEED		
OIL COOLER	WATER FLOW 40 ~ 60L/min		
	TEMPERATURE OF COOLING WATER		MAX 32°C
OPERATING TORQUE OF SHIFTING LEVER		UNDER 2.94Nm	

公差 TOLERANCE ON		번호 NO.	품 PART NO.	품 PART NAME	개수 QTY	재 MATERIAL	규 SIZE	비 REMARKS
분수 FRACTIONS	소수 DECIMALS	각도 ANGLES	제 MATERIAL		형 TYPE	DMT50A		
±	±	±	인 APPROVED BY	검 CHECKED BY	척 SCALE	도 N/S	도 DWG. NO.	원도 ORIGINAL DWG. NO.
구 구	분 분	조 조	급 급	중 중	정 정	인 인	검 검	도 도
1	초	과	4	이	하	± 0.3	± 0.1	± 0.05
4	16	± 0.5	± 0.2	± 0.07		JK.Kim	TH.Cha	MA.Kim
16	63	± 0.7	± 0.3	± 0.1				
63	250	± 1.2	± 0.5	± 0.2				
250	1000	± 2.0	± 0.8	± 0.3				
D-I INDUSTRIAL		크기 SIZE	A 3	코드 번호 CODE ID. NO.	MARINE TRANSMISSION			
						050000A~F-114DCH		
						000		